

Office 402 m²

Technopolis Gasperich, Luxembourg

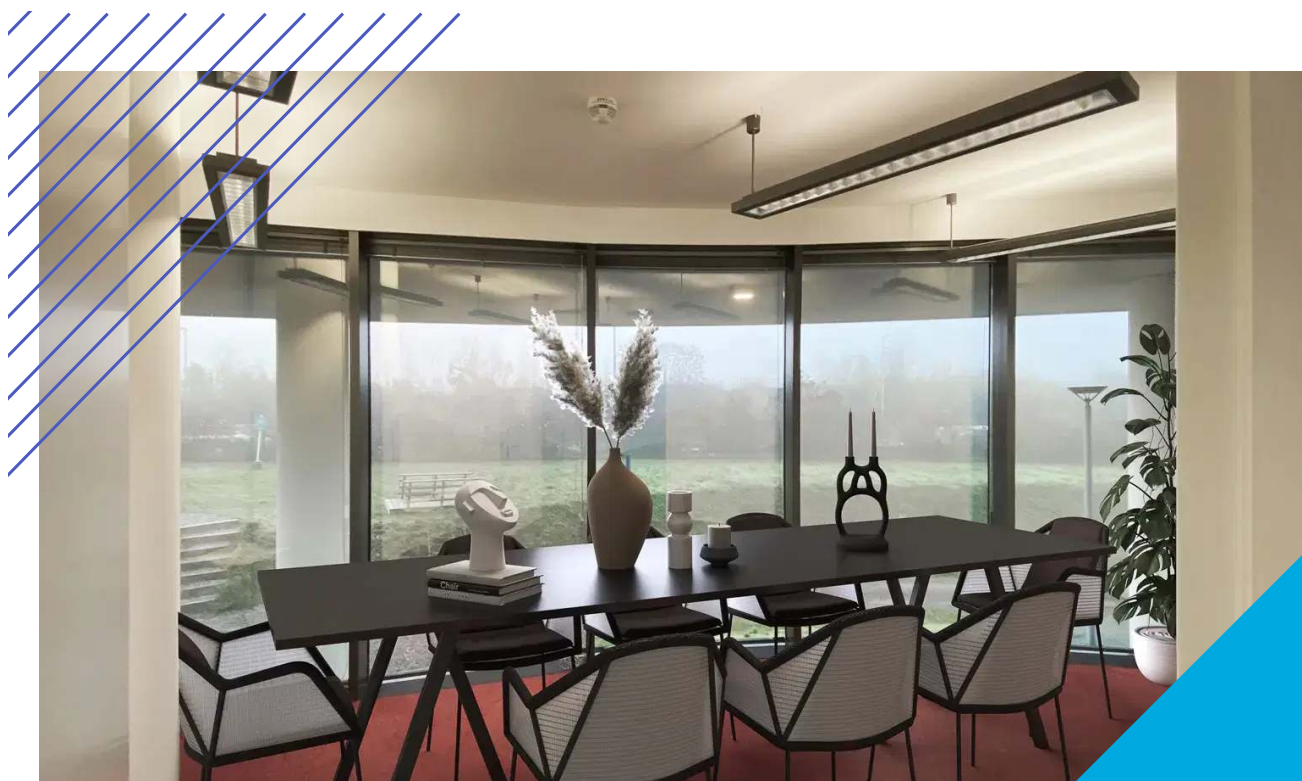

TECHNOPOLIS

OFFICE 402 M² | TECHNOLPOLIS GASPERICH

<p>Available for rent an office on the 1st floor and retail premises on the ground floor at Technopolis Gasperich in Luxembourg. Technopolis Gasperich offers modern and flexible office premises that can be modified to meet company's needs. The central railway station is around 10 minutes from Gasperich by bus or car.</p>

Area

402 m²

Floor

1-2 floor

Parking

There is a parking hall in the building.

Type

Office

Availability

Available

Address

12 rue Guillaume Kroll 1882 Luxembourg

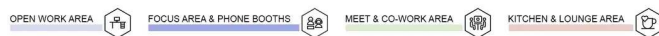
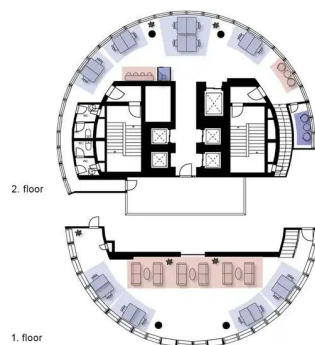
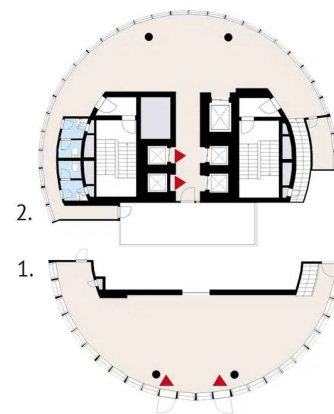
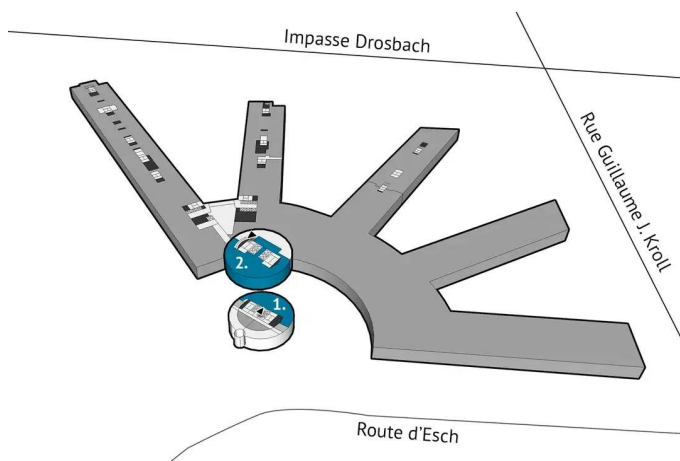



Technopolis Gasperich – Flexible office space in Cloche d’Or, Luxembourg city

Technopolis Gasperich is the ideal spot for companies of all sizes that are looking for flexible office space in Luxembourg City. You’ll find the campus in the developing business district of Cloche d’Or, which acts as a headquarters for several major businesses and European Union institutions. On Gasperich campus you get an office space that is centrally located only 5 kilometres from city center with an attractive pricing.

It’s simple to travel to and from Gasperich campus, seeing as it’s a very short distance from Luxembourg City center and close to a major highway interchange. You can easily hop on a bus from to other parts of the city and country, while a large-scale tram project will soon connect Cloche d’Or with the airport. If you want to go shopping, the biggest shopping mall in the country, LCO, is only five minutes away from the campus.

Technopolis Gasperich offers a wide range of services, such as reception, concierge service, a stylish restaurant and coffee shop as well as meeting rooms. Our services for your company also include great parking spaces, which are highly appreciated by our customers.

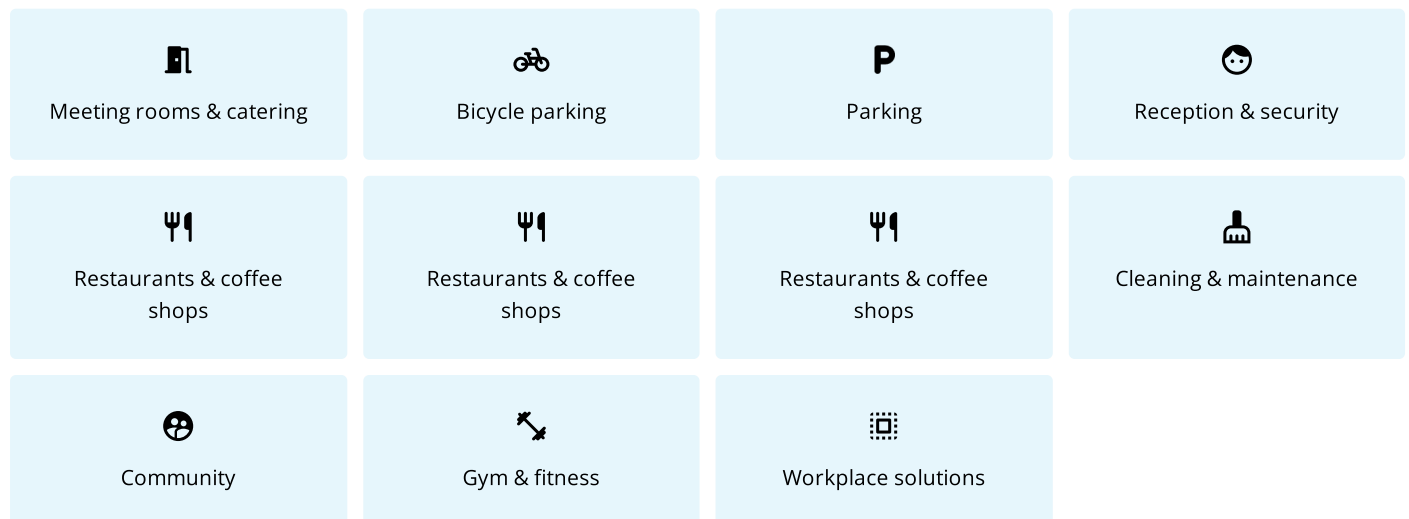



Sustainability highlights of the campus



100%

Carbon-neutral electricity

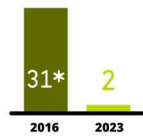

2 kg

CO₂ / gross m²
Carbon footprint

Scope 1 and 2 (energy), energy procured by Technopolis

* Technopolis buildings' average carbon footprint in 2016



100%

BREEAM Very good certified campus



A

Energy class buildings

DIRECTIONS

Technopolis Gasperich campus is located in the district of Cloche d'Or with fantastic transport connections to the city center, the airport, and quick access to the highway. The driving time to the international airport at Findel is around 15 minutes.



At Technopolis your office space change is smooth and effortless

We have thought about every detail to make the process easy for you:

- ✔ Our sales team matches your needs and wishes with the right office space. We make sure that the total package includes the flexibility and all the services you require.
- ✔ Our in-house design team helps you to plan your new workspace, from the functionality of the layout to choosing the right materials.
- ✔ Our trusted moving partners ensure your move is hassle-free by taking care of every detail from door to door.
- ✔ Our comprehensive furniture selection offers high-quality products, with the option to buy, rent, or even choose recycled furniture.
- ✔ We provide tendered partners for all your needs, from space repairs to cleaning, so you don't have to worry about everyday practical matters.

GET IN TOUCH WITH US

We will help you find the right solution for your company.



Alexandro Dozzo

Senior Asset Manager

✉ alexandro.dozzo@technopolis.lu

☎ +352 621 464 946